

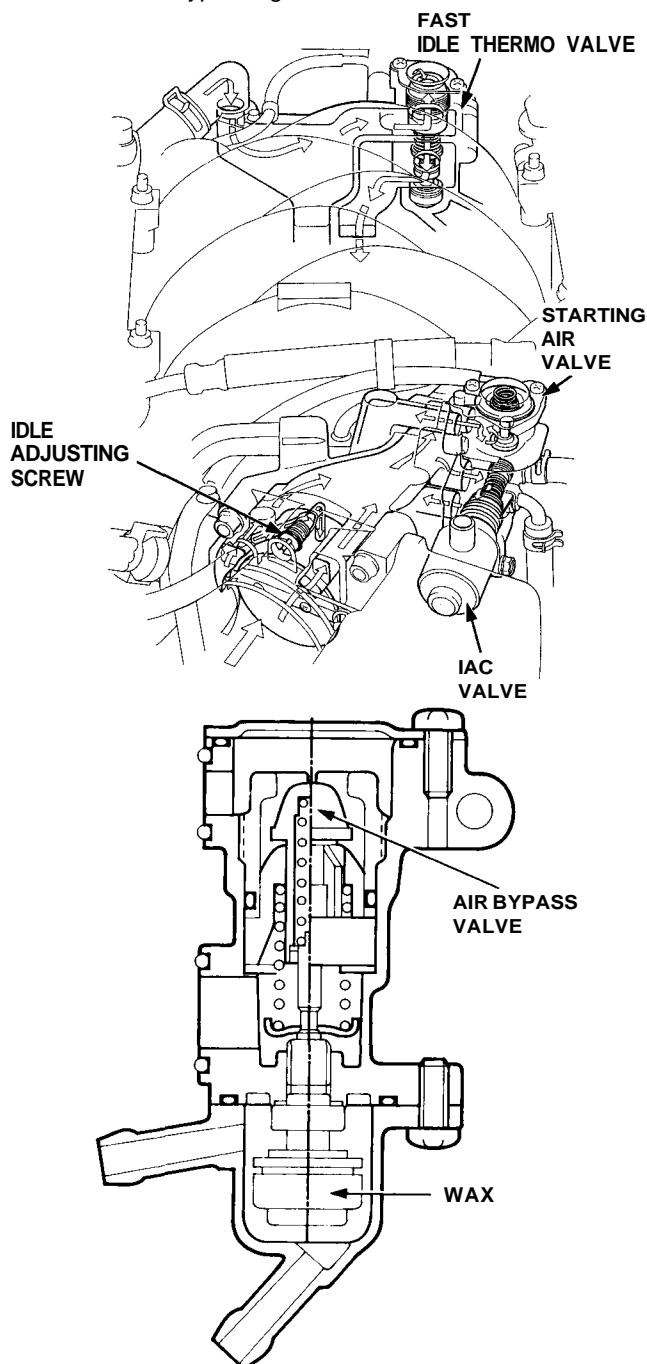

## Fast Idle Thermo Valve

### Description

To prevent erratic running when the engine is warming up, it is necessary to raise the idle speed. The fast idle thermo valve is controlled by a thermowax plunger. When the engine is cold, the engine coolant surrounding the thermowax contracts the plunger, allowing additional air to be bypassed into the intake manifold so that the engine idles faster. When the engine reaches operating temperature, the valve closes, reducing the amount of air bypassing into the intake manifold.



### Inspection

NOTE: The fast idle thermo valve is factory adjusted; it should not be disassembled.

1. Start the engine.
2. Remove the hose from pipe. Put your finger over the pipe and check for air flow (vacuum) with the engine cold (engine coolant temperature below 86°F [30°C] and idling).

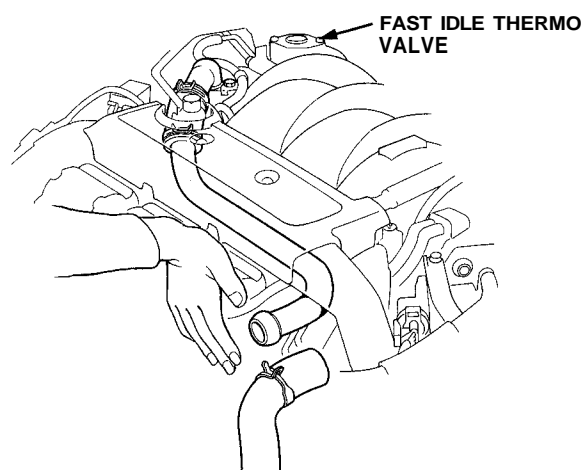

- If no vacuum is felt, replace the fast idle thermo valve and retest.

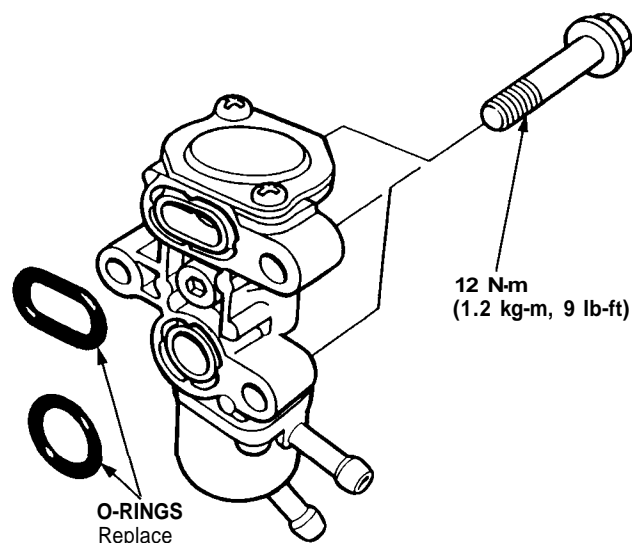

4. Warm up the engine (the radiator fan comes on).
5. Check that the valve is completely closed. If not, air suction can be felt in the valve pipe.
  - If any suction is felt, the valve is leaking. Check engine coolant level and for air in the engine coolant system. If OK, replace the fast idle thermo valve and recheck.